

## SAE O RING FLANGE - CODE 61 & CODE 62 RYCO O RING FLANGE

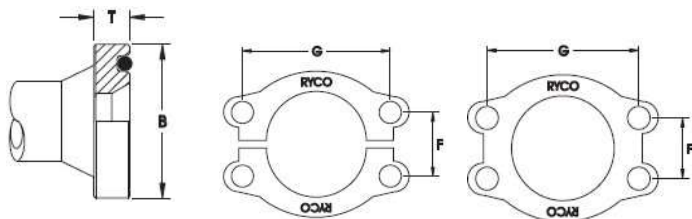

The male connector has a flange head with an O Ring groove on the face. The female can be a flange block or port with smooth face to accept the O Ring, and four threaded bolt holes in a rectangular pattern. The connection is held together using either a split or solid flange clamp, fitted over the male flange head and drawn up to the female port using the four bolts.

This compresses the O Ring forming a seal between the male flange and the flat female port face. SAE J518, DIN 20066, ISO/DIS 6162 and JIS B 8363 are all interchangeable, except for bolt sizes.

NOM. FLANGE SIZE	DASH SIZE	BØ		T		F		G		PORT THREAD & BOLT LENGTH			
										PORT	BOLT LENGTH	PORT	BOLT
inch		mm	inch	mm	inch	mm	inch	mm	inch	UNC	inch	METRIC	mm
CODE 61													
1/2	-8	30,2	1.19	6,73	0.265	17,5	0.69	38,1	1.5	5/16 – 18	1.1/4	M8 x 1,25	35
*5/8	-10	34,0	1.34	6,73	0.265	19,8	0.78	42,9	1.69	5/16 – 18		M8 x 1,25	
3/4	-12	38,1	1.5	6,73	0.265	22,2	0.88	47,6	1.88	3/8 – 16	1.1/4	M10 x 1,5	35
1	-16	44,5	1.75	8,00	0.315	26,2	1.03	52,4	2.06	3/8 – 16	1.1/4	M10 x 1,5	35
1.1/4	-20	50,8	2	8,00	0.315	30,2	1.19	58,7	2.31	7/16 – 14	1.1/2	M10 x 1,5	40
1.1/2	-24	60,3	2.38	8,00	0.315	35,7	1.41	69,8	2.75	1/2 – 13	1.1/2	M12 x 1,75	45
2	-32	71,4	2.81	9,53	0.375	42,9	1.69	77,8	3.06	1/2 – 13	1.1/2	M12 x 1,75	45
2.1/2	-40	84,1	3.31	9,53	0.375	50,8	2	88,9	3.5	1/2 – 13	1.3/4	M12 x 1,75	45
3	-48	101,6	4	9,53	0.375	61,9	2.44	106,4	4.19	5/8 – 11	1.3/4	M16 x 2,0	45
CODE 62													
1/2	-8	31,7	1.25	7,75	0.305	18,2	0.72	40,5	1.59	5/16 – 18	1.1/4	M8 x 1,25	35
3/4	-12	41,3	1.63	8,76	0.345	23,8	0.94	50,8	2	3/8 – 16	1.1/2	M10 x 1,5	40
1	-16	47,6	1.88	9,53	0.375	27,8	1.09	57,2	2.25	7/16 – 14	1.3/4	M12 x 1,75	45
1.1/4	-20	54,0	2.12	10,29	0.405	31,8	1.25	66,7	2.63	1/2 – 13	1.3/4	M14 x 2,0	45
1.1/2	-24	63,5	2.5	12,57	0.495	36,5	1.44	79,4	3.13	5/8 – 11	2.1/4	M16 x 2,0	60
2	-32	79,4	3.13	12,57	0.495	44,5	1.75	96,8	3.81	3/4 – 10	2.3/4	M20 x 2,5	70
RYCO CODE 62C													
3/4	-12	41,3	1.63	14,20	0.559	23,8	0.94	50,8	2	3/8 – 16	1.3/4	M10 x 1,5	45
1	-16	47,6	1.88	14,20	0.599	27,8	1.09	57,2	2.25	7/16 – 14	1.3/4	M12 x 1,75	45
1.1/4	-20	54,0	2.12	14,20	0.599	31,8	1.25	66,7	2.63	1/2 – 13	2	M14 x 2,0	50

RYCO Code 62C fittings conform to the flange OD and bolt hole patterns of SAE Code 62 but require special flange clamp halves. The RYCO Code 62C flange heads are thicker than SAE Code 62 and measure T = 14,2 mm (0.559") in all sizes. RYCO Code 62C flanges have similar dimensions to the Caterpillar XT-5 and XT-6 range of flanges. Cat™ Caterpillar®, XT-5™, XT-6™ Caterpillar®. \*5/8 is used by Komatsu.